



SPRINGFIELD-GREENE COUNTY

Botanical Center

HOURS: Sun 11 am-6 pm
417-891-1515 Mon-Sat 8 am-8 pm

2400 S Scenic, Springfield MO 65807

This facility is a welcome center to nearly 30 outdoor gardens and is the home of Friends of the Garden, Greene County University of Missouri Extension, and botanical staff for the Springfield-Greene County Park Board. You can learn more about the volunteer organizations that maintain these plant collections by using the Guide By Cell® self-guided tour (see inside).

Visit Us Inside the Building:

- Master Gardeners of Greene County Hotline
- Rooftop Plaza · Workshop Studio · WiFi
- Greene County Extension's Plant Diagnostics Lab
- Gift Shop & Botanical Reference Library
- Available for Meeting Space & Social Events
- Current and Upcoming Event Info

Education, Exhibits & Attractions:

- Hands-On Art & Garden Workshops for All Ages
- Greene County Extension Training Courses
- Guided School Programs & Tour Groups
- Rotating Garden & Art Exhibits, Flower Shows
- NatureGrounds® Naturalized Playground
- Five PlayCore® Play Pods along the play trail
- South Creek Greenway Trailhead

Nathanael Greene|Close Memorial Park

26 gardens create a place of beauty and wonder, a resource that brings research, education, and community together.

Dr. Bill Roston Native Butterfly House

10 am-6 pm, Saturdays & Sunday · Free · May-Sept
Tues. & Wed. 5 pm to Dusk · Get an up-close look at native butterflies as they lay eggs, then transform to caterpillar, to chrysalis, and finally to butterfly! Guides will answer your questions in what is the largest Native Missouri Butterfly House. For private group tours call 891-1515.

Free Garden Tram Service

1-5 pm, Saturdays & Sundays · May-Sept
Board the tram at the Botanical Center. It circles most of the park with interim stops along the way. Group weekday tours available, call 891-1515.

Master Gardener Hotline Office & Gardens

9 am-4:30 pm, Monday - Saturday · March - October
Have home garden questions? Call 881-8909 ext. 320 or email greenemg@missouri.edu. Bring in an insect or diseased plant for diagnosis. We're here to help! Don't miss the demonstration gardens which include a mixed perennial border, themed herb beds, ornamental grasses, Missouri natives, turf plots, & a kitchen garden.

Mizumoto Japanese Stroll Garden

9 am-7:30 pm, Thursday-Monday, April-October
\$3 per person; 12 & under free, 864-1049
Enjoy serenity and peace in the fully landscaped 7.5 acres founded in 1986. Experience winding paths, ponds, tea house, bridges, bonsai shelter, moon bridge, pagoda, and meditation garden. Watch for annual festivals.

The Gray-Campbell Farmstead

1:30-4:30 pm most Sundays, April-October, 725-4921
Visit the oldest house in Springfield, MO. Discover life in the 1860's through displays, hands-on activities, programs, heritage garden, and annual expositions.

South Creek Greenway Trail

This is the quintessential 8-mile urban trail, set in a natural landscape. Walk, bike or jog along the newest part of the National Recreation Trails System. Trailhead includes parking and restrooms. 3-miles of hard surface trail runs throughout the park.

Host Lions Club History Walk

Discover 26 granite stone lawn markers with a history of famous Americans north of the Botanical Center.

Get Involved: Volunteer!

Gardener or not, you can help. Bring your enthusiasm and we'll work with your interest, skill, and schedule, all ages welcome! Opportunities include assisting with tours, programs, special events, office projects, exhibits, docents and more. If you'd like to help in the gardens, there are plenty of seasonal tasks, or consider adopting a garden. Email: info@friendsofthegarden.org.

Guided Group Garden Tours

Special guided group tours of the Botanical Center & Gardens are available upon request, call 891-1515.

A Look Back: History of the Park

The new 12,700 sq. ft. Botanical Center rests on a hillside in the 55-acre Close Memorial Park, just south of 59-acre Nathanael Greene Park. Known as Nathanael Greene|Close Memorial Park, the 114 acres share the main entrance from Scenic Ave. Open dawn to dusk.

Nathanael Greene is named after a major general of the Continental Army in the American Revolutionary War. The land was received as surplus property from the U.S. Dept. of the Interior and Bureau of Prisons in 1975.

Close Memorial was established in cooperation with the Springfield-Greene County Park Board in 1998. The purchase was made possible in part through a donation from the C.M. Close family. A MO Dept. of Conservation grant in 2003 helped expand the park and clear it to create open space.

Federated Garden Club Gardens

Annuals and perennials are planted and maintained by Brentwood, Cherry Court, Ever Green and Hillbilly Gardeners Garden Clubs.

Missouri Native Arboretum

Throughout Close Park, several native tree species are identified with green signs which teach about our Missouri forests. Brown signs indicate non-native and ornamental trees and shrubs. These serve as guides for the homeowner. The latest additions include the Cercis (Redbud), Dwarf Conifer, and Azalea Gardens.

Weddings & Events in the Park

Schedule your special days at The Botanical Gardens. Contact The Botanical Center for venue info: 891-1515.

Grow With Us! Become a Friend of the Garden...

We're individuals & families who support The Botanical Center & Gardens in its mission to provide outstanding botanical, horticultural and environmental education opportunities for people of all ages. Anyone with an interest or appreciation in nature who wish to support the progress of the gardens is encouraged to join. As a member, you're a partner in the future of the gardens.

Member Benefits: Membership begins the day we receive your form.

- Friends of the Garden Membership Card · Fully Tax Deductible
- Free Season Admission for Two into the Mizumoto Japanese Stroll Garden* (*excluding the Japanese Fall Festival)
- Subscription to the FOG Quarterly Newsletter · Ongoing Learning
- Volunteer Opportunities · Form Lasting Friendships
- Give Back to Your Community · Special Invitations to FOG Garden Events
- Annual Events: Bluegrass & Blossoms, Butterfly Festival



Membership makes a thoughtful gift: A tax-deductible gift membership to FOG is perfect for a birthday, special occasion, or any reason! Simply fill out the form below and your friend or family member will enjoy all the benefits of being a member. Additional donations go to the *FOG Growth and Maintenance Fund*.

membership levels

- \$ 500 Benefactor
- \$ 250 Patron
- \$ 100 Sponsor
- \$ 50 Contributor
- \$ 25 Friend
- renewal**
- additional donation**
\$ _____

gift memberships available at all levels

- wedding birthday in honor of*
- holiday anniversary other*

corporate sponsorship

- \$1,000 Platinum
- \$ 500 Gold
- \$ 250 Silver
- \$ 150 Bronze

lasting dedications

- \$800 Four Foot Bench*
- \$500 Tree*
- \$250 Shrub*
- \$ 50 Engraved Brick*

*specify person or event, email for details

receive newsletter via: Snail Mail Email

name _____

address _____

city _____ state _____ zip _____

email _____ phone _____

gift recipient* _____

address _____

city _____ state _____ zip _____

email _____ phone _____

Mail & Payable to: Friends of the Garden | PO Box 8566 | Springfield MO 65801

learn more

george deatz | 417-840-5472
 dr. robert kipfer | 417-883-9382
 bob childress | 417-838-9454

web friendsofthegarden.org

phone 417-891-1650

email info@friendsofthegarden.org

facebook friends of the garden

As used by the Smithsonian, Central Park in New York City, and the San Diego Zoo!

Dial & Discover the Gardens!

- 1 Self Guided Phone Tour**
Call 417-213-3016
- 2 Enter Garden Number Below**
- 3 Enter [#] Key**

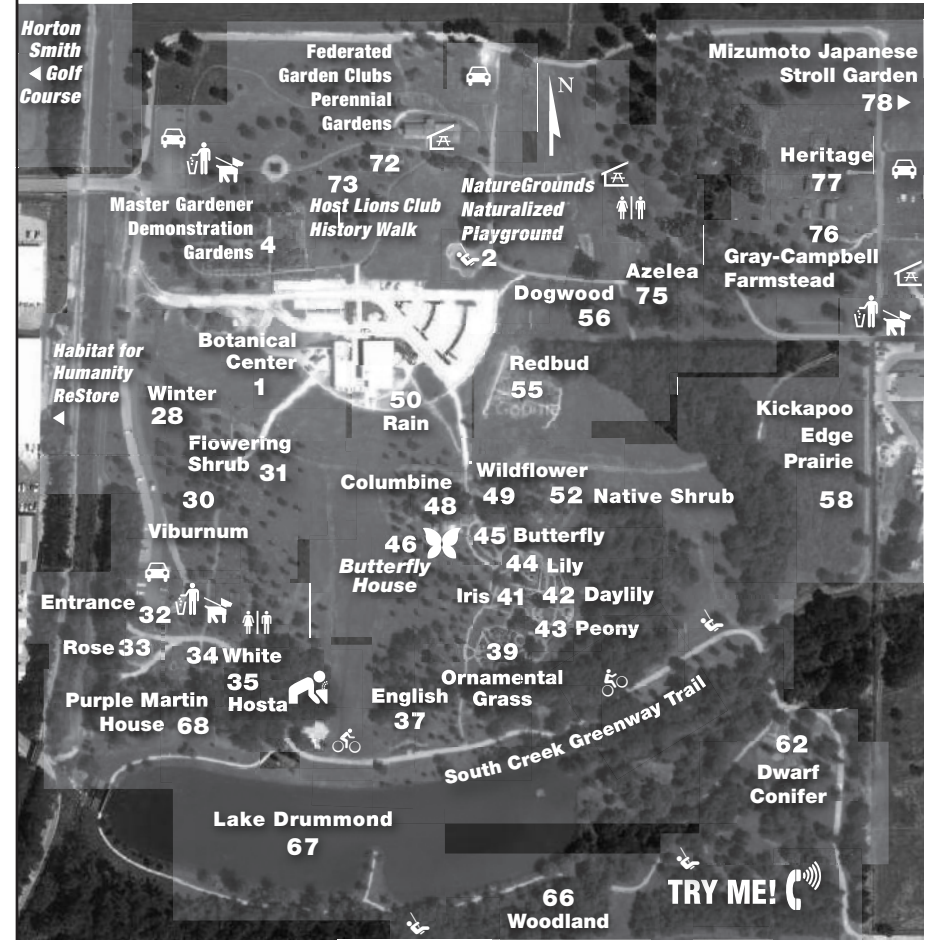

Self-Guided Cell Phone Audio Tour by **Guide-By-Cell**® No cost except your minutes!